

A L I E N W A R E™



# Alienware 27 Gaming Monitor

## AW2720HF

Reviewer's Guide – July 2019

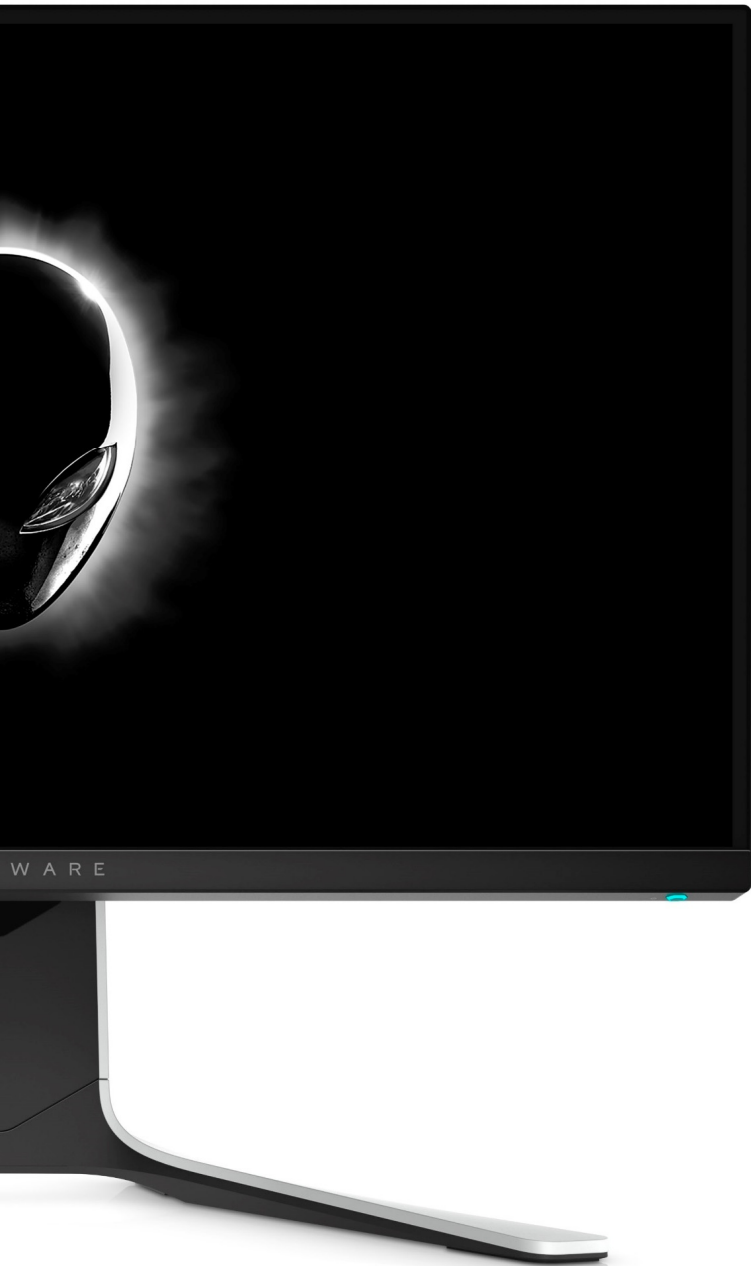

## Table of contents

Feature Overview	3-6
Product Gallery	7-11
Ecosystem of Accessories	12
Technical Specs	13
About Alienware	14



# Alienware 27 Gaming Monitor Feature Overview

## SPEED THAT EXCEEDS

---

### Every Frame. Every Advantage.

Introducing the new, ultra-fast Alienware 27 Gaming Monitor. Clocking in at a 240Hz native refresh rate and a true 1ms response time, this monitor lets you *see faster*.

Having both speed and high quality images is made possible by the new, fast IPS (in-plane switching) technology that allows for the ultra fast 1ms gray-to-gray response time while still delivering on the well-known benefits of IPS: high color accuracy and wide-angle viewing.

With the speed and image quality of the Alienware 27 Gaming monitor, dominate the gaming world with your honed split-second reactions that let you best your opponent with a lightning-fast no-scope before they even know you're there.



### Furiously Fast

- **A 240Hz refresh rate** is 4x faster than typical standard monitors and twice as fast as common 120Hz gaming monitors. More frames means smaller visual information gaps, which means a faster reaction time for the gamer. There's a 8.3 millisecond gap between frames at 120Hz, which is halved to 4.16ms between frames at 240Hz. This is incredibly important to gamers playing at breakneck speeds, and provides an edge over gamers less well-equipped. Combined with skill, get more wins by being able to react in real-time.
- **The true 1ms response time** blasts away motion blur. The pixels are able to change quickly and respond to the new image signal as it comes in. This is a new feature for IPS monitors, which have typically been considered too slow for gaming. The 1ms response time (with Overdrive) here is a true, Gray-to-Gray measurement on an IPS, wide viewing angle panel, rather than other alternative response time specifications.
- **AMD Radeon FreeSync™** technology synchronizes the GPU and monitor, displaying full frames only when the monitor is capable of displaying them. This minimizes graphic distortions such as tearing and artifacts from forming on screen, allowing you to experience native refresh rates up to 240Hz for rapid-fire, tear-free graphics that don't require user adjustments. As a result, you'll lose yourself in smooth, responsive gameplay with an incredibly fast 1ms response time, and enjoy sharp, undistorted images.





## The Best of Every World

- **A large, 27" screen** strikes the perfect balance for gamers that play more immersive games as well as competitive, fast-paced games. Get a bigger view of the battlefield and line up a headshot from 2 clicks out or just drink in the environment of the fantastic world surrounding you.
- **The native FHD (1080p) resolution** keeps games sharp. When gamers are looking for speed, it's common to reduce a game's resolution down to 1080p. If this is done on a non-native screen, such as a QHD monitor, the 1080p game will end up being blurry in full-screen mode, or smaller in windowed mode. Don't down-res! Play the game sharp in the full-screen 27" glory.
- **99% sRGB color coverage**, brought to you by fast IPS, looks incredible. This is color coverage not found in typical TN panel gaming monitors, and makes the game world every bit as colorful as the designers imagined.
- **A wide-angle viewing range** means that color coverage is consistent no matter which angle the screen is viewed from. This is thanks to the IPS technology that the monitor is built on. Considering the large 27" screen, this means that the colors in the corners don't wash out when the gamer is fixated on the center of the screen, and over-the-shoulder spectators can see you take your well-earned victory.

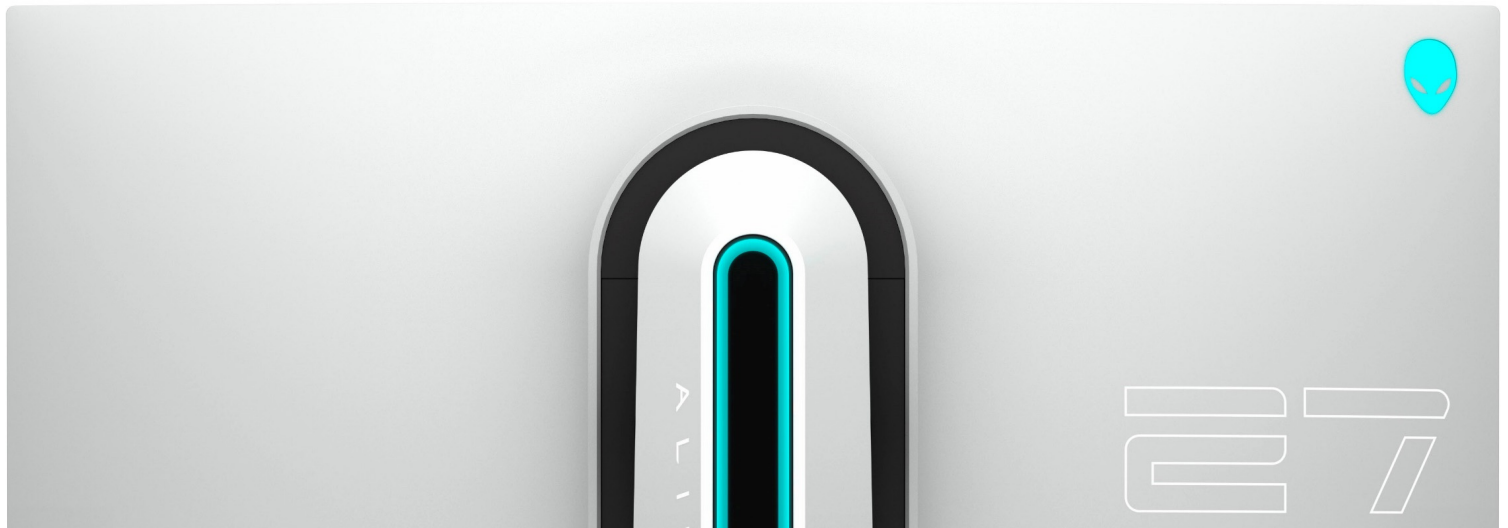

# Alienware 27 Gaming Monitor Feature Overview

## A Legend Arises

- **The new Alienware design**, known as Legend, has been introduced into the Alienware monitor lineup. It is a bolder, sculpted, universal, minimal and iconic expression of the Alienware brand. The entire Alienware ecosystem have adopted this language so that your battle station looks great anywhere you place it.
- **The Lunar Light** color offers distinct contrast at every angle, with large fluid surfaces with the soft-white of the moon and dark areas within the stand and monitor core providing a deep-space feeling. The monitor head design funnels towards the stand, providing a floating, weightless look, and the futuristic, hexagonal patterns elegantly vent heat from the monitor core.
- **A stellar stand** offers height adjustability, tilt, pivot, and swivel so that the monitor can be adjusted to whatever gaming setup is needed. The quick-release VESA mount allows for easier portability or swapping out to customized rigs.
- **The sturdy, tapered base** has legs that are designed to slip easily under a gaming keyboard so that there's no interference on the desk as a gamer moves the keyboard to their battle-ready position
- **A cable management chamber** allows for cables to pass through the stand discreetly to easily connect to the ports within the hidden compartment on the back of the monitor. An easy, magnetic slip-on cover hides the cables, while internal cable-guides have them routed and tamed. Additionally, the center gap of the stand allows for cables going from a mouse and keyboard to pass under the stand and to the gaming system neatly and cleanly.





# Alienware 27 Gaming Monitor Feature Overview



## The Gaming Details

Alienware is built for gaming, and our rich history of developing the best gaming machines and engagement with our gaming community means that we understand gamers and their needs well. That's why, in addition to the amazing specs and thoughtful design, we continue to enrich the gaming experience with these enhanced features to help gamers gain the competitive edge.

- **AlienFX customizable lighting** allows gamers to set the mood with the Alienware head logo, the continuous light strip on the stand, and the power button set as a single customizable zone with full RGB values. Have it set for different game profiles, or allow it to react to in-game action (compatible game required) to add to the experience.
- **Thoughtful port placement** is more than just a factor of convenience, it's an essential. With a 3.5mm headphone jack and two USB 3.1 Gen 1 ports on the front underside, connect your favorite peripheral as you're swapping out game stations or plug in other temporary devices, like gamepads.
- **Convenient monitor controls** are easily reached on the right side of the monitor, with a new joystick for navigating menus quickly and intuitively. The individual buttons can be assigned as shortcuts for the gamer's preferred tools and settings.
- **Dell Premium Panel Exchange** allows a free panel replacement during the Limited Hardware Warranty\* period even if only one bright pixel is found.
- **A Gaming-Centric On-Screen Display** menu provides access to enhanced game features, such as a FPS counter, timer, display alignment feature, and preset and customizable game modes for the best pre-calibrated settings or user profile customization.



# Alienware 27 Gaming Monitor (AW2720HF) Product Gallery – Dimensions

---

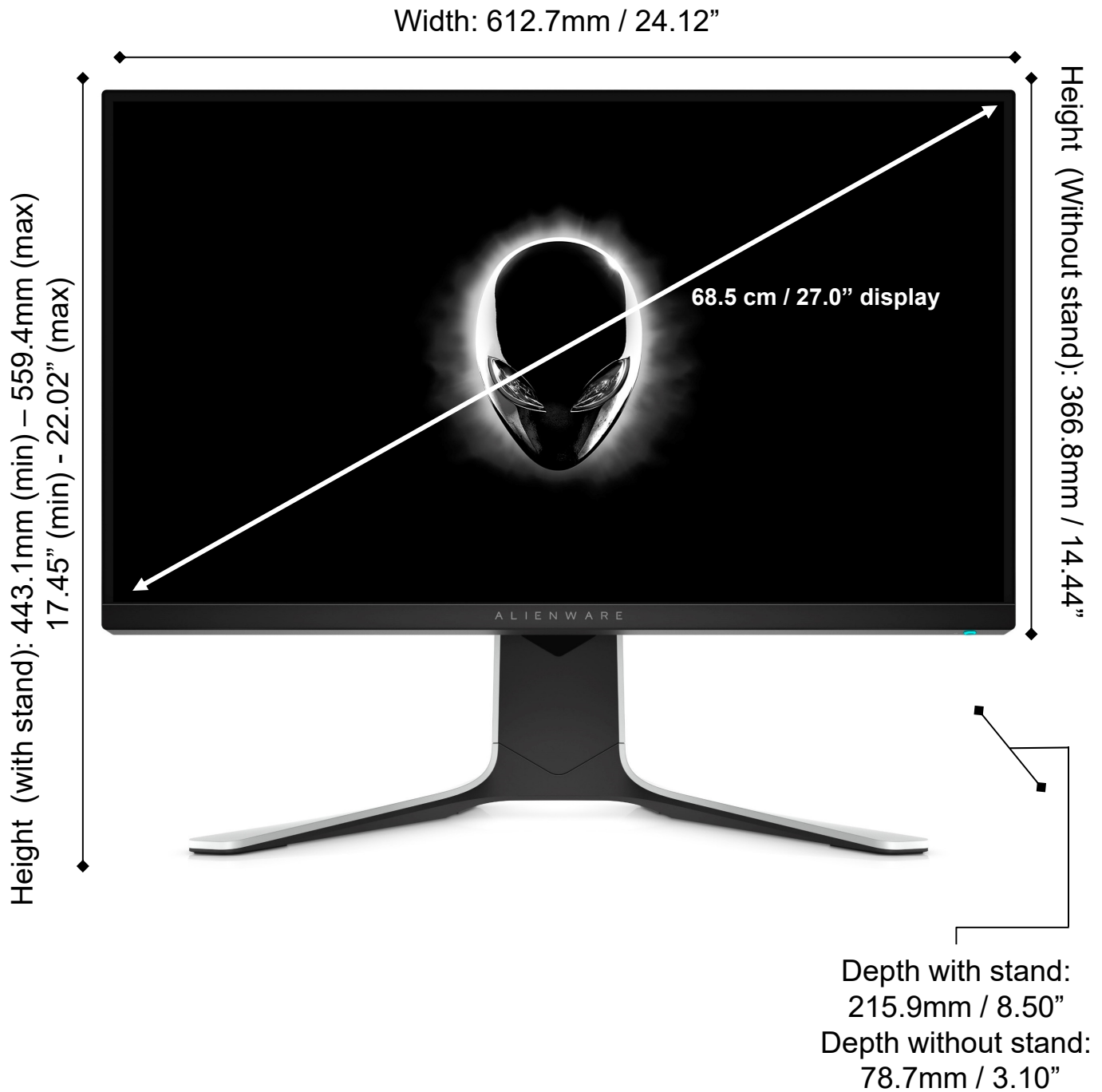

# Alienware 27 Gaming Monitor Product Gallery – Front View

---

27" FHD (1920x1080) fast IPS  
antiglare LED backlit screen  
with 99% sRGB color coverage



Cable management  
chamber

Power button

I/O peripheral cable  
access





# Alienware 27 Gaming Monitor Product Gallery – Rear View

---

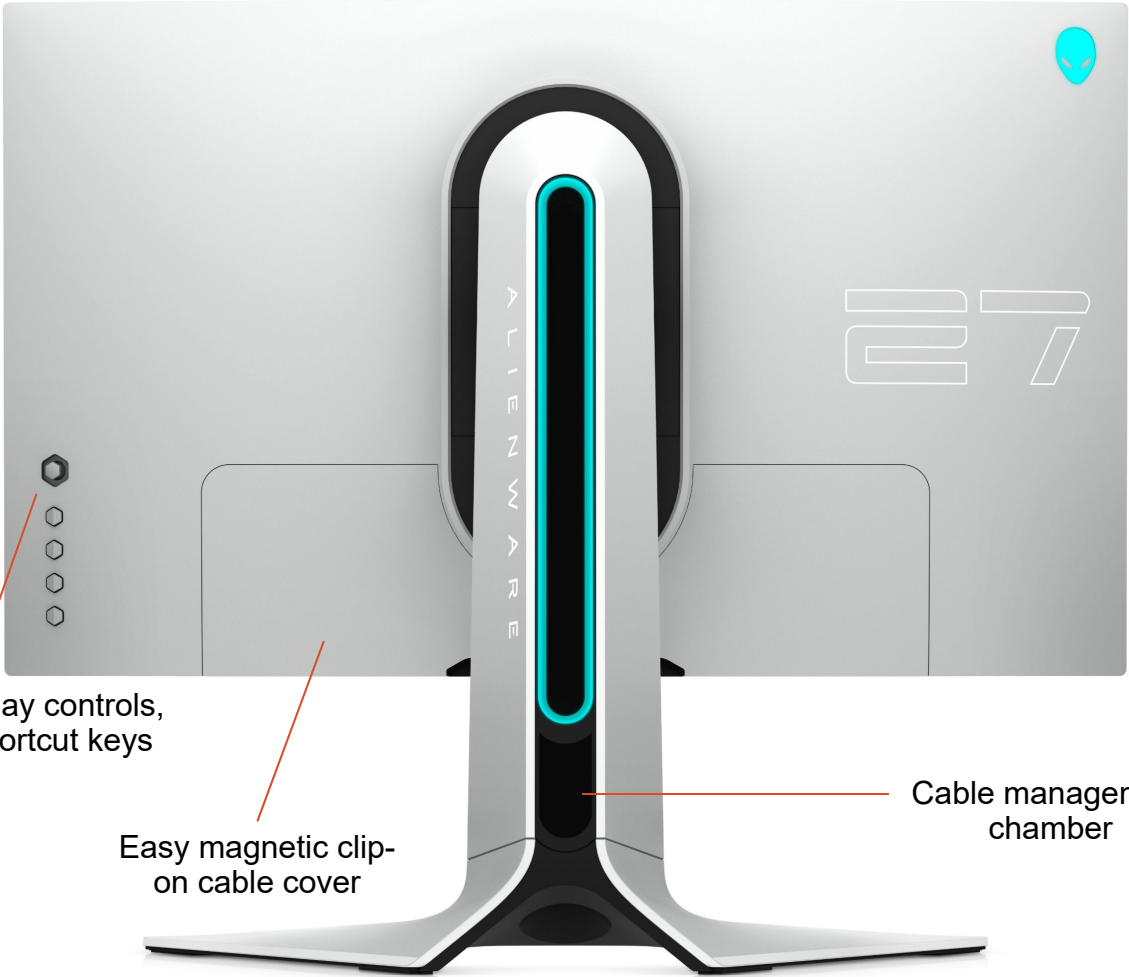

On-screen display controls,  
joystick and shortcut keys

Easy magnetic clip-  
on cable cover

Cable management  
chamber



# Alienware 27 Gaming Monitor Product Gallery – Side View

---

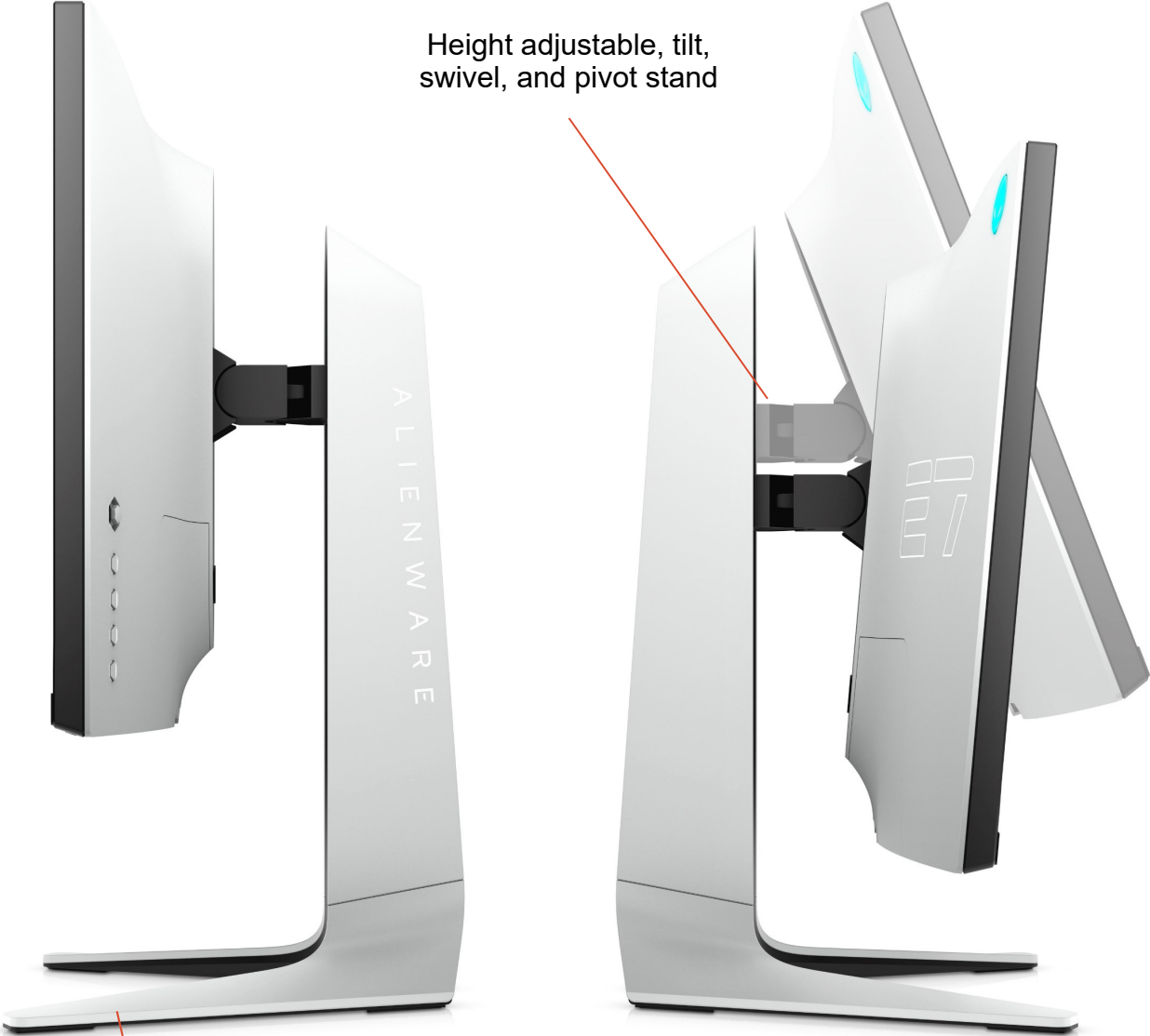

Tapered base with low-profile legs slides under keyboards



# Alienware 27 Gaming Monitor Product Gallery – Ports

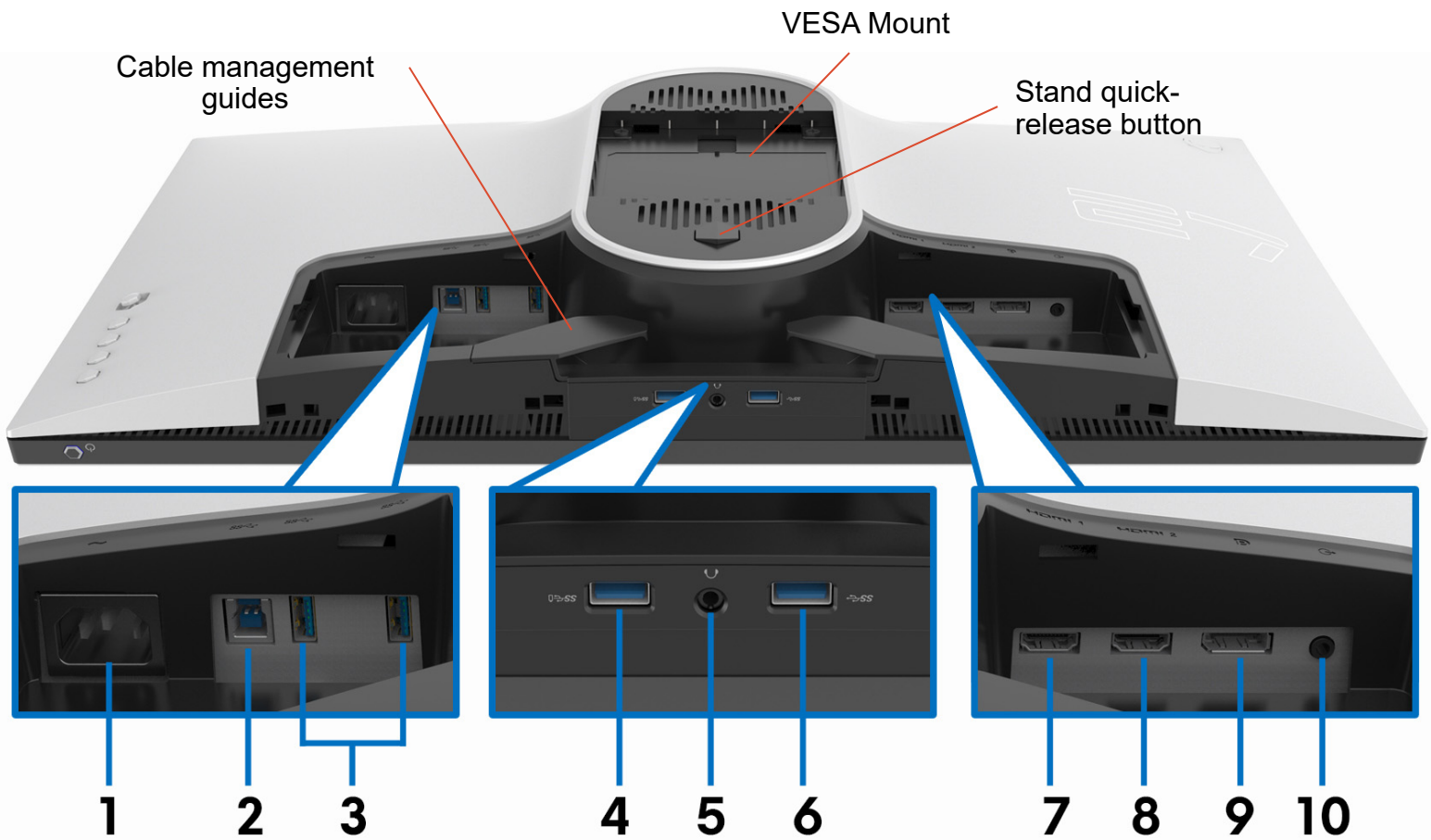

- |                                      |                    |
|--------------------------------------|--------------------|
| 1. Power in                          | 6. USB 3.1 Gen 1   |
| 2. USB Upstream                      | 7. HDMI            |
| 3. USB 3.1 Gen 1 (2x)                | 8. HDMI            |
| 4. USB 3.1 Gen 1 with Power Charging | 9. DisplayPort     |
| 5. Headphone Jack                    | 10. Audio Line-out |



# Ecosystem of accessories

Complete your experience with accessories designed to bring the Alienware Legend look and feel into your whole setup so that you can dominated on a coordinated battle station.

## **Alienware Advanced Wireless Gaming Mouse – AW610M**

Full-sized wireless gaming mouse with up to 300 hours of play per single AA battery and six fully programmable buttons for performance that takes no prisoners.

## **Alienware Gaming Headset – AW510H**

Hear every sound in your games on the Alienware 7.1 Gaming Headset, showcasing 7.1 surround sound with Alienware Immersive Audio technology.



## **Alienware Advanced Gaming Keyboard – AW510K**

Intelligently designed to deliver exceptional performance, value and essential gaming functionality in a compact design.



# Features & Technical Specifications

## Alienware 27 Gaming Monitor

### Display

### AW2720HF

<b>Viewable image size (diagonal)</b>	68.5 cm (27.0")
<b>Active display area (horizontal x vertical)</b>	596.7mm x 335.7mm (23.49" x 13.22")
<b>Panel technology</b>	Fast IPS
<b>Display Screen Coating</b>	Antiglare with 3H Hardness
<b>Maximum preset resolution</b>	Full HD 1920 x 1080, 240 Hz
<b>Typical viewing angles (vertical / horizontal)</b>	178° / 178°
<b>Pixel pitch and Pixels Per Inch (PPI)</b>	0.27675 mm x 0.27675 mm, 82 PPI
<b>Aspect ratio</b>	16:9
<b>Brightness (typical)</b>	350 cd/m <sup>2</sup>
<b>Color gamut (typical)</b>	99% sRGB
<b>Color depth</b>	16.78 million colors
<b>Contrast ratio (typical)</b>	1,000 : 1
<b>Response time (typical)</b>	True 1ms (gray to gray) with Overdrive
<b>Backlight</b>	LED edgelight system
<b>ComfortView<sup>1</sup></b>	Yes
<b>AlienFX Lighting</b>	Yes – 1 zone, 3 lights (Logo, Power Button, Rear Light Strip)
<b>Connectivity</b>	2x HDMI 2.0, DP 1.2, USB 3.1 Gen 1 upstream, 4x USB 3.1 Gen 1 downstream (1 with Power Charge), 1x Headphone-out jack, 1 x Audio Line-out jack
<b>AMD FreeSync™</b>	Yes
<b>Stand adjustability</b>	Height adjustable stand up to 130 mm, Tilt (-5° to 21°), Swivel (-20° to 20°), Pivot (-90° to 90°)
<b>Stand features</b>	Built in cable-management
<b>VESA mount compatible</b>	Yes, 100 mm x 100 mm, with quick release button
<b>Power</b>	
AC input voltage/frequency/current	100 VAC to 240 VAC / 50 Hz or 60 Hz ± 3 Hz / 1.5 A (typical)
Power consumption (typical/maximum)	29W / 73W
Power consumption (standby/sleep mode)	<0.3 W
<b>Dimensions (HxWxD)</b>	366.8 mm x 612.7 mm x 78.7 mm
Panel only	(14.44" x 24.12" x 3.10")
Monitor head with stand (compressed/extended height)	443.1 mm – 559.4 mm x 612.7 mm x 215.9 mm (17.45" – 22.02" x 24.12" x 8.5")
<b>Weight</b>	
Panel only (for VESA)	4.8 kg (10.58 lbs)
Monitor and cables with full packaging	12.8 kg (28.24 lbs)
<b>Compliance Standards</b>	Product Safety, EMC and Environmental Datasheets Dell Regulatory Compliance Home Page Dell and the Environment
<b>Standard service plan</b>	3-year Advanced Exchange Service <sup>2</sup> & Premium Panel Exchange
<b>What's Included</b>	Monitor panel, Stand riser, Stand base, Cable Cover, Power cable, 1x HDMI cable, 1x DisplayPort cable, 1x USB 3.1 Gen 1 (upstream) cable, Quick setup guide, Drivers and documentation media, Safety Information

<sup>1</sup>ComfortView feature reduces blue light emission and optimizes eye comfort.

<sup>2</sup>Advanced Exchange Service: Replacement part/unit dispatched, if needed, following completion of phone/online diagnosis.

Fee charged for failure to return defective unit. Availability varies. Other conditions apply.

<sup>3</sup>For a copy of the Limited Hardware Warranty, write Dell USA LP, Attn: Warranties, One Dell Way, Round Rock, TX 78682 or see Dell.com/warranty.





# About Alienware

---



## **About Alienware**

Alienware, Dell's high performance PC gaming brand, offers unique and award-winning PCs that incorporate innovative engineering, aggressive design and the most advanced components in the industry. Credited as being one of the first PC gaming hardware manufacturers, Alienware remains committed to creating industry-leading trends in high-performance gaming and being an active and influential member of the gaming community, connecting, fans, developers and manufacturers for the advancement of PC gaming. Learn more at <http://www.alienware.com/>.

## **Review System Information**

Alienware, under the guidance of Dell Inc., provides this equipment for evaluation purposes only.

All equipment must be returned to Dell Inc. in good working condition. Equipment must be in its original box, including all packaging, documentation, cables, and diskettes. This equipment remains the property of Dell Inc. unless paid for in full by the evaluator. Dell Inc. reserves the right to collect from the evaluator the full retail value of the equipment if not returned promptly and in good working condition on or before the due date. An online shipping return label will be provided.

